

Camray 5 utility manual

Installation & maintenance manual for Camray 5 Combi External Boilers

Page 1 of 57

Installation & maintenance manual for Camray 5 Combi External Boilers



By Appointment to
H.M. Queen Elizabeth II
Boulter Boilers Limited
Boiler Manufacturers

Heat is our Element



Health & Safety

INFORMATION FOR THE INSTALLER AND SERVICE ENGINEER.

Under the Consumer Protection Act 1987 and the Health and Safety at Work Act 1974, it is a requirement to provide information on substances hazardous to health (COSHH Regulations 1988).

The Company takes every reasonable care to ensure that these products are designed and constructed to meet these general safety requirements, when properly used and installed.

To fulfil this requirement products are comprehensively tested and examined before dispatch.

This appliance may contain some of the materials below.

When working on the appliance it is the Users/Engineers responsibility to ensure that any necessary personal protective clothing or equipment is worn appropriate to parts that could be considered as being hazardous to health and safety.

INSULATION & SEALS

file:///D:/PL61500/PL61500.htm

14/04/2005

File Name: Camray 5 utility manual.pdf

Size: 3552 KB

Type: PDF, ePub, eBook

Category: Book

Uploaded: 26 May 2019, 19:44 PM

Rating: 4.6/5 from 553 votes.

Download Now!

Please check the box below to proceed.



I'm not a robot



reCAPTCHA
Privacy - Terms

Book Descriptions:

Camray 5 utility manual



If you continue without changing your settings, we will assume that you are happy to receive all cookies on the website. However, you can read our Cookie Policy here. Accept and Continue. Under the Consumer Protection Act 1987 and the Health and Safety at Work Act 1974, it is a requirement to provide information on substances hazardous to health COSHH Regulations 1988. The Company takes every reasonable care to ensure that these products are designed and constructed to meet these general safety requirements, when properly used and installed. BOULTER BOILERS Boulter Boilers Limited Magnet House, White House Road, Ipswich IP1 5JA. Before using your new Boiler, we ask that you carefully read the following information. It is the responsibility of the installer to ensure that the Boiler is commissioned. If an engineer is not known, Boulter Buderus will be pleased to provide details of commissioning and servicing engineers from their register. Your Installer should give guidance on this. This is perfectly normal and should be no cause for concern. Note The nozzle on this appliance is only covered by a 1 year guarantee. The isolating switch must have all pole contact separations at least 3mm BOULTER BUDERUS CAMRAY 5 PAGE 7 35 DIMENSIONS Output. The chimney should comply with the latest edition of the Building Regulations and BS 5410 Part 1. A high level outlet should be provided for ventilation. BOULTER BUDERUS CAMRAY 5 PAGE 11 47 OIL STORAGE 47.1 Oil Tank Consideration to the access by fuel delivery lorries should be given when positioning the oil tank. As there is only one tapped outlet they are more suited to single pipe feed as gravity supply or with a Boulter 3K Oil Loop Deaerator where suction lift is required. The Flexible Oil Pipes are fitted inside the Boiler casing and are of adequate length to enable the Burner to be removed without disconnecting. Click the Programmer in place from the front.

6. <http://www.styrexon.cz/userfiles/dirt-devil-kinetix-manual.xml>

- **camray 5 utility manual, camray 5 utility manual, camray 5 utility manual pdf, camry 5 utility manual download, camry 5 utility manual transmission, camry 5 utility manual for sale.**

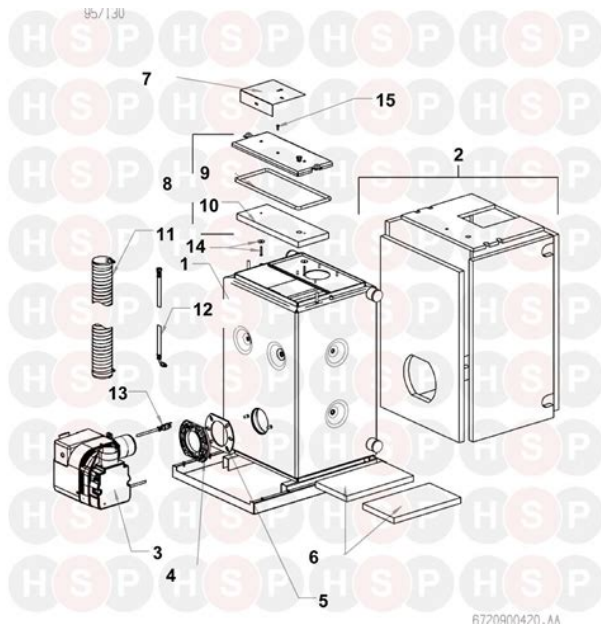

Fitting Instructions for the programmer are included in the Programmer Kit. These may be as required but can be easily changed if not. Test enables a quick review of the 7 day programme. This enables a period of days to be set up to 99 during which time the Heating System is OFF. When the Holiday Period is over the Programmer reverts back to the normal programme. Balanced Flues permit considerable choice of siting of the Boiler. Boilers may be installed in situations where no chimney exists, where the chimney is unsatisfactory or in outhouses. Due to the efficiency levels of Camray 5 plumbing from the terminals may occur under certain conditions. The illustration shows a typical rear outlet flue. Assemble the flue generally as follows 1. Available from Boulter Buderus. 17. Inside Using the clips supplied fix the flexible air duct to the burner spigot and flue offtake securely. The following illustrations show boilers up against a rear wall as an example. It is not essential for the boiler to be positioned this way; As long as the joists are capable of supporting the flue via the support plate supplied in the kit. Continue with the rest of the installation. The following illustrations show boilers up against a rear wall as an example. It is not essential for the boiler to be positioned this way. As long as the joists are capable of supporting the flue via the support plate supplied in the Kit or the Flue support quadrant kit optional. Continue with the rest of the installation. This is attained by pushing two telescopic flues together until the desired dimension is obtained. Secure any vertical lengths by using a drill and 4 self tapping screws supplied. If an engineer is not known Boulter Boilers will be pleased to provide details of commissioning and servicing engineers from their register. Outer valve Filter Sludge cock Non plastic tanks. HEIGHT OF TANK Is the bottom of the tank above the oil pump if a single pipe system is installed. <http://www.yumeguri.jp/userfiles/dirt-devil-handy-zip-manual.xml>

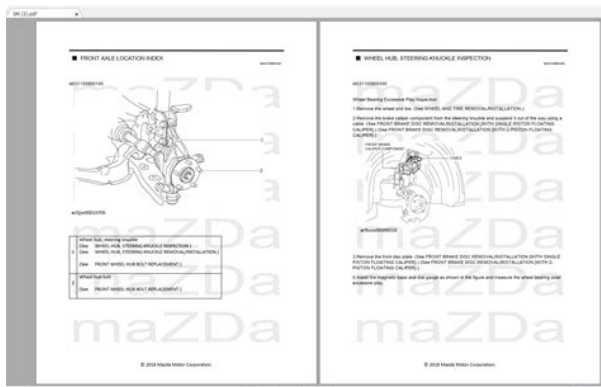

OIL SUPPLY LINE Ensure that galvanised iron has not been used. BOULTER BUDERUS CAMRAY 5 PAGE 41 74 BOULTER BUDERUS RECOMMENDED COMMISSIONING CHECK LIST SHEET 2 OF 2 CASING PANELS Have grommets been fitted to relevant oil supply entry points knockouts Is the flue free of any obstruction. Has the chimney been adequately lined and insulated. NOTE Lining the flue and back filling will help prevent condensate problems BALANCED FLUE APPLIANCES Is the correct flue kit fitted. Is the Flue off take correctly secured to the boiler by four nuts and washers. GENERAL Has the boiler been installed in accordance with manufacturers instructions. BOULTER BUDERUS CAMRAY 5 PAGE 42 75 BOULTER BUDERUS RECOMMENDED COMMISSIONING TESTS Have the manufacturers onsite assembly instructions been followed Instruct the user on the operation of the appliance and leave this manual with the customer. CHANGE the nozzle for one with the specified make, oil rate, spray pattern and angle. Inspect the ignition electrodes for crazing in the porcelain. Replace if there are signs of deterioration. A dirty fan impeller can impair the performance of a burner, inspect and clean if necessary. To adjust the CO at the Air Shutter use a 3mm allen key as shown. BOULTER BUDERUS CAMRAY 5 PAGE 45 101 FAULT FINDING If the Boiler fails to start, make the following checks before calling a service engineer 1. BOULTER BUDERUS CAMRAY 5 PAGE 53 Burner starts but will not This can be due either to light up absence of oil of ignition. BOULTER BUDERUS CAMRAY 5 PAGE 54 Burner pulsates Worn nozzle with Replace with nozzle of correct type and size see a continuously excess throughout or Technical Data. Due to a policy of continual development Boulter Buderus reserves the right to alter or amend the design of its products without prior notice. Page 1 of 40. Camray 5 External Boilers. Heat is our Element. Making the most of your energy1. Manual Part No. PL61000. Issue No. 2.

Date of Issue December 2003The Company takes every reasonable care to ensure that these products are designed and constructed toTo fulfil this requirement products are comprehensively tested and examined before dispatch. This appliance may contain some of the materials below.Camray 5 External Boilers. Page 2 of 40. Glass Rope, Mineral Wool, Insulation Pads, Ceramic Fibre, Fibre Glass Insulation. May be harmful if inhaled. May be irritating to the skin, eyes, nose or throat. When handling avoid inhalationUse disposable gloves, face masks and eye protection. After handling wash hands and other exposed parts. When disposing, reduce dust with water spray, ensureGlues, Sealants and Paint are used in the product and present no known hazards when used in the mannerSeek immediate medical attention for any rash, wart or sore developing on any partDo not fire the Burner in the open i.e. out of the Boiler as a miss fireBarrier cream containing lanolin such as Rosalex Antisolv, is highly recommended together with a strictUnder no circumstances should mineral oils be taken internally. Rectification of Oil Firing Equipment should be consulted. Boulter Buderus Limited. Magnet House, 30 White House Road, Ipswich IP1 5JA. Telephone 01473 241555. Fax 01473 241321Camray 5 External BoilersOil Delivery. Page 3 of 40Recommended Commissioning Check List. Recommended Commissioning tests. SECTION 2 INTRODUCTION Check ListPage 1Thank you for choosing the Camray 5 External boiler manufactured in the UK by Boulter Buderus who areBefore using your new boiler, we ask that you carefully read the following information. All Boulter Buderus appliances are the result of many years of research, development and experience.

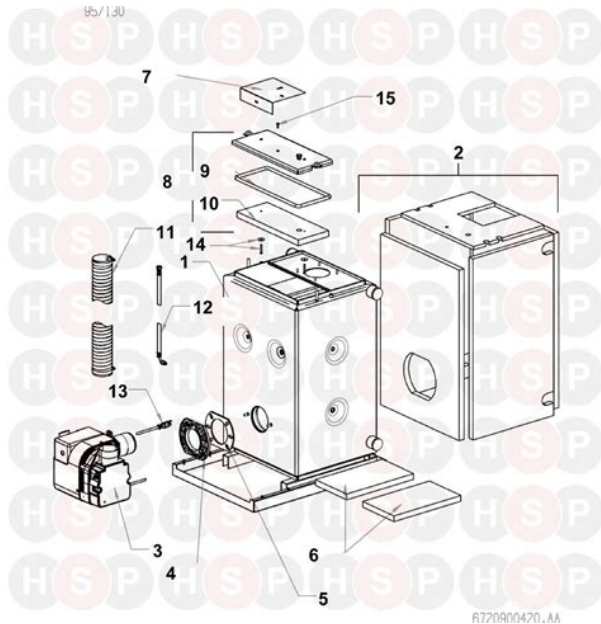

<http://ninethreefox.com/?q=node/10780>

Whist our boilers are designed with simplicity of operation in mind, there are certain features and benefits we trust that you will enjoy many years of reliable service from your new Boulter Buderus and, once again, your Boulter Buderus Boiler has built-in safety features, which are detailed. The heating system must comply with the latest editions of British Standards 5410 and the Building Regulations. Page 4 of 40 Installer or by way of a Local Building Control License. An OFTEC CD 10 document or Building Control Completion Certificate must be obtained. If an engineer is not known, Boulter Buderus will be pleased to provide details of a commissioning and if it is known or suspected that a fault exists on the Boiler, it MUST NOT be used until the fault has been rectified. It is essential that the instructions in this booklet are strictly followed for safe and economic operation of the boiler. We recommend that you keep these instructions in a place near your appliance for easy reference. Page 5 of 40 Clearances provided at the sides and rear of the appliance for air entry must be kept free of obstruction. For your Boulter Buderus Boiler should be connected to an electric supply complying with the Electrical Wiring Regulations BS 7671 as well as an oil supply complying with the BS 5410 Pt.1; and an appropriate flue. ALWAYS SWITCH OFF THE ELECTRICAL SUPPLY before removing any of the covers for cleaning. After your Boulter Buderus Boiler has been installed it MUST be commissioned by a competent O.F.T.E.C. Commissioning involves testing the Boiler. If the Boiler has not been commissioned, it may not be operating at the maximum power. Page 3 Thermostat to the OFF position. The Boiler Control Thermostat controls the water temperature within the Boiler. The recommended Control Thermostat settings are as follows: Camray 5 External Boilers.

<http://dieter-sauter.com/images/brita-ultramax-dispenser-manual.pdf>

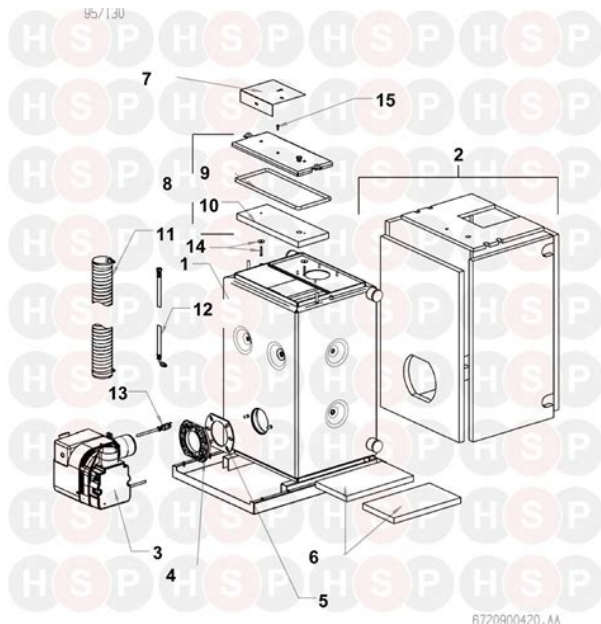

Page 6 of 40 Wait for the Boiler to cool, and then reset the thermostat by pressing the limit thermostat reset button located If this problem still persists turn off the Boiler and consult your installer. To reset the Burner, wait for a period of at least 45 seconds. Press the lockout reset button located on the If this problem still persists, turn off the Boiler and consult your engineer. Camray 5 External Boilers. Page 7 of 40 Thorough cleaning Remember, when the Boiler is required, to ensure that the oil Camray 5 External Boilers. Page 8 of 40 This is to allow any sediment to settle and not be drawn into the Boiler. If not this could result in an We advise that you keep your Boiler off for one hour after the oil delivery to your tank. Please ask your Page 5 For normal cleaning of the outside casing, simply wipe with a damp cloth. To remove stubborn marks and DO NOT use abrasive cleaning materials. Page 9 of 40. The Boiler must be serviced at regular intervals by a qualified service engineer. Failure to have the Boiler. Using Kerosene Class C2 fuel, the Boiler should be serviced at twelve monthly intervals to ensure that the Please also note that grilles on the casing door must not become blocked. They should be inspected regularly Due to the high efficiency of the boiler white water vapour from the flue discharge called pluming may be This is perfectly normal and should be no cause If the Burner fails to start, adopt the following procedure Is there oil in the tank Page 10 of 40. Page 6 The Boulter External Boiler is Boilers are supplied with a manual reset limit thermostat. The terminal guard supplied with the boiler MUST be fitted. Page 11 of 40 If an engineer is not known, Boulter Buderus will be pleased to provide details of commissioning and See OFTEC CD11 form on page 20. See Section 7 for Commissioning Procedure. Page 7 Wiring should not be tampered with, modified or Non compliance with the above will invalidate Guarantee. Practice for Oil Firing BS 5410 Part 1. Page 12 of 40.

<https://difumarket.com/images/brita-pitcher-instruction-manual.pdf>

GREENSTAR CAMRAY UTILITY & UTILITY SYSTEM
12/18, 18/25, 25/32

FLOOR STANDING OIL FIRED CONDENSING BOILER
CONVENTIONAL FLUE & ROOM SEALED FLUE

FOR FULLY PUMPED OPEN VENT OR SEALED CENTRAL HEATING SYSTEMS AND DOMESTIC
HOT WATER CYLINDERS

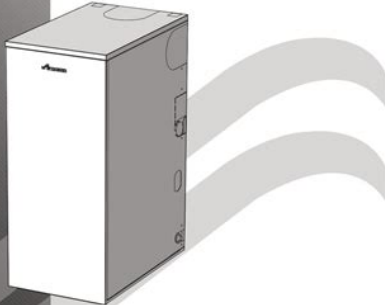

THE APPLIANCE IS FOR USE WITH 28 SECOND KEROSENE
ONLY

GB

INSTRUCTION MANUAL
INSTALLATION COMMISSIONING
& SERVICING

WORCESTER
Bosch Group

Class C2 Kerosene. This fuel is suitable for this boiler. Burners are supplied with all appropriate nozzle and pump pressure as they are for midrange output. Details of all nozzle sizes and pump pressure for all water resistance less than 300 m.m.w.g. Page 8 Pressure Jet supplied as standard. Manually adjustable air regulator. The burner must be set to details given in section 36. For further details of the burner, refer to the burner data sheets supplied in the literature envelope. See page 27 for exploded diagrams of Riello RDB Burners. Page 13 of 40. Page 9 Output. Model Riello. Nozzle Pump. Pressure. Bar Fuel. Rate Flue Exit Temp °C BS 5410 Oil Installations. Pt 1 up to 44kW. Pt 2 and over 44kW. Page 14 of 40. BS 5449 Forced circulation hot water central heating systems for domestic premises. BS 7593 Code of practice for the treatment of water in domestic hot water central heating systems. BS 7671 2001 Electrical Wiring Regulations. Part L Northern Ireland. The Control of Pollution Oil Regulations. Oil boilers should be installed in accordance with good practice as recommended by OFTEC Ref. 23. Commissioning. Page 10 It is not the purpose of When designing and installing the controls of the heating system, it must be remembered that if the control If this condition is likely wire the controls so that the electrical supply to the burner is switched off On existing heating systems where a Boiler is replaced, ensure that the system is chemically cleaned. The system should contain clean water and be free from leaks. Suitable inhibitors against limescale and Refer to BS 7593. Kettling and system noises can be avoided by suitable pretreatment i.e. Chemical Cleaning at the onset. This is essential when fitting a new boiler to an existing system. Page 15 of 40. The noise level from Buderus Boilers is quite low and installations have not given rise to complaints. Consideration must be given however, to the following points.

Further advice from Buderus should be This Boiler model is serviced from the front. The boiler requires a level hearth on If the Boiler is to stand on a floor made of combustible material then protection between the Boiler and the Consideration should be given to the weight of the Boiler and the Building Regulations regarding floor loading. Page 16 of 40. Due to the weight of this appliance, consideration should be given if you intend to site this on decking. If you These must be free from obstruction. Consideration to the access by fuel delivery lorries should be given when positioning the oil tank. Tank Flared fittings should be used wherever possible. Soft soldered joints must not be

used. Page 17 of 40. Page 12 It is essential for reliable operation that an Oil Filter is fitted in the Oil Pipe supplying Oil from the Tank. The filter should be fitted as close to the Boiler as practicable but not fitted to or inside the boiler. It is a condition of the guarantees that a suitable Filter is fitted correctly. A remote acting FIRE VALVE must be fitted in the suction line at the time of installation see BS 5410 Part 1. The valve must be fitted external to the Boiler. The sensor should be located above the Burner in the capillary. Length. Operating. Temperature. Camray 5 External Boilers. Page 18 of 40. If the bottom of the Oil Tank is above the Oil Burner, install a 10mm copper supply pipe to the Burner. Ensure that the Burner Oil Pump is correctly set for Single Pipe operation. The boiler is supplied set for Page 13. When the bottom of the Oil Tank is below the level of the Oil Pump on the Burner it is necessary to install a Non Return Valve. The Non Return Valve must be fitted to allow the flow in the correct direction and prevent drain back to the Tank. Ensure that Valves are NOT fitted in the Return Line. The Return Line must be unobstructed at all. Ensure that the Burner Oil Pump is correctly set for Two Pipe operation.

<http://www.restorationservice.ca/wp-content/plugins/formcraft/file-upload/server/content/files/1626fd14dbc76d---bose-panaray-system-digital-controller-user-manual.pdf>

Page 19 of 40. An alternative two pipe arrangement can be achieved using a 3K Oil Loop Deaerator which removes the air. The Burner Pump is piped to the Deaerator, which should be positioned. A Non Return Valve is not required in the return line. The advantage of this system is gained where a two pipe run from the oil supply tank is long or difficult to Camray 5 External Boilers. Page 20 of 40. Page 14. For changeover applications the use of a Water Separator Oil Filter, available from Boulter Buderus is. The burner is supplied set for single pipe operation. The return port is plugged and the Bypass Screw is not. Camray 5 External Boilers. Page 21 of 40. For two pipe oil systems the Burner Oil Pump has to be fitted with the Bypass Screw supplied. Boilers are. This socket screw is inserted. The carton contains the boiler burner and flue exhaust and guard. Camray 5 External Boilers. Page 22 of 40. Connect a permanent supply and a switched line as shown in Fig 412. Page 23 of 40. Pass the flex from the system control panel into the boiler control panel making sure that the grommet. The boiler control panel is fitted with a Frost Protection thermostat. This control panel requires a PERMANENT live supply as well as a switched live supply from the external. The permanent supply must be connected to the terminal 3. The switched wire to terminal 1. The Neutral must only be connected to terminal 2 and the Earth wire must be connected to terminal 4. Failure to correctly wire this appliance will create an immediate danger to life and will invalidate any warranty. Page 24 of 40. Using a 100mm. Using the EDPM seal, fix. Push the ducting through the seal. The use of a high modulus silicon with provide a very good. Camray 5 External Boilers. Page 25 of 40. It is possible to route the flow and return pipes through the back panel.

BAHETH24AQARI.COM/ckfinder/userfiles/files/bre-video-game-manuals.pdf

To do this you have to remove the. Invert the door assembly and. Make sure the plastic blanking cap is fitted to. Page 17. Standing in front of the boiler, the flow pipe is fitted to the left hand tapping on top of the heat exchanger. The. We have shown the pipe being dressed to the back. Page 26 of 40. Page 18. Page 27 of 40. It is mandatory requirement that terminals of flues, which can be touched, are to be fitted with a guard. Any proposed installation, which deviates from the details provided or gives rise to any doubt, should be. Terminal. Opening, door. Window. Page 19. If an engineer is not known Boulter Buderus will be pleased to provide details of commissioning and. Commissioning must be carried out at the point of first firing. Incorrect commissioning can cause premature fouling of the flue ways. It is essential that the. It is recommended that the relevant section of BS 5410 Part 1 latest edition is carefully read. It is recommended that you use a report sheet and checklist. Make comments on the report where necessary, A suggested layout is shown over. Page 29 of 40. Page 20. Site Address. Appliance Model. Serial No. Fuel. Tick off each item. Is there sufficient oil, and of the correct grade for the appliance. Is the tank adequately supported. Is a damp proof membrane inserted between the

tank and support Non plastic tanks.. Does the tank slope at least 20mm per meter of length downwards towards the sludge cock Non plasticIs the tank painted or suitably protected externally Page 30 of 40. Is the tank fitted with the following. Contents gauges. Screw fill and independent vent cover or capped fill and vent pipes. Outer valve. Filter. Sludge cock Non plastic tanks.If black iron has been used, is it protected against corrosion Ensure that soldered connections on copper pipes have not been used. Is the size of the pipe adequate for the boiler rating Are all joints leak proof Is a fire valve fitted Is a filter fitted correct way round.

Is the oil line connected to the correct inlet connection of the pump Disconnect the oil supply as close to the burner as possible and drain approximately a gallon of oil into aInspect the oil for impurities and repeat the process if necessary. Do not reconnect the oil until water and all impurities have been removed from the oil supply. IF NOTDoes the return oil line terminate in the take at the same level as the suction outletAre the thermostat phials inserted in their pockets Are the baffles and bottom insulation where applicable correctly located Is the boiler set for the fuel being supplied Has the system and boiler been filled with water and inhibitor as required Is the boiler flueway inspection cover screwed down sufficiently firmly to form a seal Page 21Remove the burner. Is the correct nozzle fitted NOTEBurner operating instructions can conflict because they are intended for general guidance. Since thePage 31 of 40. Have the manufacturers onsite assembly instructions been followedSet the boiler thermostat to between Summer and Winter positions. Switch on the electric supply to the boiler, checking that programmes are switched to the ON position, andWhen the burner motor starts, on one pipe systems it may be necessary to temporarily open the air bleedOnce the burner is firing check and if necessary adjust the oil pressure. If the burner locks out during ignition attempt, wait 45 seconds before pressing the reset button on theAre the electrical input connections to the control panel correct Is the supply fuse correct Does the wiring comply with the latest IEE regulations Is the power supply cable to the control panel properly clampedAdjust the air shutter if necessary, open to reduce CO₂, close to increase CO₂. If the shutter is adjusted, recheck the Smoke No. Check the flue gas temperature. The figures should agree with the Boiler Commissioning Data. Check lockout function, either cover the photocell or remove solenoid coil, to simulate flame failure.

Reinstate components and press the lockout button. Check the operation of the limit thermostat. Complete commissioning report OFTEC CD 11 and enter the details on to the guarantee form whichInstruct the user on the operation of the appliance and leave this manual with the customer. Page 22With the Boiler operating, inspect for signs of unsatisfactory operation, i.e. leakage of combustion products. Page 32 of 40Check the commissioning list if it is your attendance to the appliance. Is there a reason why the Boiler mightIt is useful to measure the combustion data, i.e.CO₂, Smoke No. and flue gas temperature, and a check onMaintenance Procedure. Switch off electrical supply at the MAINS ISOLATING SWITCH.Check the correct grade of oil is being used.Change paper elements for new.Remove flue inspection cover, and baffles, and clean all heat transfer surfaces and baffles. Replace anyCheck that the control thermostat is operating when the set temperature is reached. Check the operation of the limit thermostat if possible. Reset Limit Thermostat once appliance temperature has dropped sufficiently. Complete a maintenance report and give the customerRemove burner and clean thoroughly, the burner draught tube, the electrodes and generally the headInspect the ignition electrodes for crazing in the porcelain. Replace if here are signs of deterioration. A dirty fan impeller can impair the performance of a burner, inspect and clean if necessary. Inspect photocell, if badly discoloured, change it. Inspect the flexible oil hose for leaks or discoloration. Use only replacement flexible oil hoses that are detailedCamray 5 External Boilers. Page 33 of 40Switch on the electric supply to the boiler. When the burner motor starts, on one pipe systems, it may be necessary to temporarily open the air bleedOnce the burner is firing check and if necessary adjust the oil pressure. Carry out combustion checks by inserting probes into sampling points provided or at the flue outlet. Check Smoke No.

, if clean wait 10 minutes and measure CO₂. Adjust the air shutter see Fig 8.2a, if necessary, open to reduce CO₂, close to increase CO₂. If the air shutter is adjusted, recheck the Smoke No. The figures should agree with data in Boiler Commissioning Data, Section 3. Page 23 To adjust the CO₂ at the Air Shutter use a 3mm Allen key as shown. To increase the setting turn the air Page 34 of 40. Page 24 Are all fuel supply valves open turned fully anticlockwise and ball valves open Is the mains electricity supply switched on Is the programmer or Boiler Operating Switch set to call for heat Is the Boiler Thermostat set to the desired temperature Is the Lockout Reset Button on the Control Box and Control Panel neon illuminated. If so, press to reset. Burner. If it blows again, call a Service Engineer. Page 35 of 40. IMPORTANT Electrical Safety Possible Cause. Action. No oil in tank. Check and arrange for Supply valves closed. Open Blockage in oil supply Gravity head feed. Shut off the burner Disconnect the oil Place Wrong grade of oil. Check for correct Technical Data. Water contamination. Open Tank vent blocked. Check. Filter blocked. Check or water or Air locks in supply pipe. Check for high points Air lock in pump. Bleed pump, check Interruption or absence of electrical supply at Check mains switch Check fuse in Check Control Box is locked out, refer to symptom 4. Press reset button on Photoresistor receiving false light. Check that the photoresistor is fully home Faulty control box. Replace. Page 28. Trouble or Complaint. Page 36 of 40. Possible Cause Photoelectric cell not receiving light from flame. Check oil in the tank. Check that photoelectric cell is clean Photoelectric cell connections loose. Check and tighten if Control Box photoelectric cell circuit faulty. Replace control box. Flame instability. Check Oil pump air locked repeat air locking may be due Pump should be self to poor pipe joints or defective gland packings Ignition failure. Motor not driving pump shaft.

Check that flexible Blocked atomiser nozzle. Remove and replace Oil pressure abnormally low. Check oil pressure on Technical Data. Solenoid valve faulty. Break union at outlet Pump rotation incorrect. Electrodes dirty. Inspect and clean if Electrodes miss set. Inspect and reset gap Cracked electrode insulator. Check and replace if Electrode leads. Check Reset Worn atomiser nozzle. Oversize nozzle fitted in error. Check make, type and Replace if necessary. Check Camray 5 External Boilers. Page 37 of 40 Nozzle incorrectly stamped. Replace with correct Burner air supply inadequate. Inspect air intake and Burner oil pressure excessive. Check pressure and Technical Data. Page 29. Trouble or Complaint Burner lights up, runs Air in nozzle Action. Should self correct; if Magnetic valve not operating correctly. Inspect and replace if Shut off piston in pump sticking. Burner Pulsates. Air supply setting incorrect or fan inlet blocked. Inspect and reset or Grossly oversized nozzle. Checked and replace Data. Air supply inadequate. Check fan operation Worn nozzle with excess throughout or uneven Replace with nozzle Data Purge at pump to Blocked flue ways. Clean boiler and flue. Burner locks out on morning Localised low voltage supply in early morning Check Electricity Board to fit Air present in oil supply. Restart Bottom of oil tank below level of oil pump. Raise tank or install a Nonreturn valve faulty or air leak in two pipe oil Renew Inspect Camray 5 External Boilers. Page 38 of 40 Motor seized. Check by hand and Breakdown of insulation of motor windings. Replace motor. Check nozzle size Boiler has become undersized due to heating Check with heating Low efficiency and CO₂. Check Low efficiency due to high flue gas temperature. Clean Faulty boiler stat. Replace, check and Page 30. Possible Cause. Low CO₂. Check High CO₂. Check High smoke. Check Check all baffles are High flue gas temperature. Check air shutter, Technical. Data, Leaking joints. Break all leaking Control stat failed and operating on limit stat.

Replace control stat Limit. Thermostat. Inadequate draught due to unsatisfactory chimney Take See Commissioning. Page 39 of 40. List Servicing Notes. Page 31. Buderus is one of the largest heating groups worldwide and enjoys a market leading position in sales of high efficiency gas condensing boilers in Europe. Boulter Boilers was acquired by Buderus in December 2002, Boulter Boilers has over twenty years of experience in the oil fired boilers market and Buderus has been Our philosophy is to provide products designed to meet the needs of our customers, which means that we Our oil fired boilers are manufactured in Ipswich, Suffolk and the condensing boilers are imported from the.

Dutch organisation, Nefit Buderus. All products are approved to meet exacting European standards relating to quality, safety, efficiency and the ISO 9000 approval system. To contact us. Boulter Buderus Ltd. Magnet House, Ipswich IP1 5JA. All information is correct at time of going to press.

<https://www.thebiketube.com/acros-3m-x62-projector-manual>